

**TO:** SWALE JOINT TRANSPORTATION BOARD  
**DATE:** Monday 14<sup>th</sup> March 2011  
**SUBJECT:** VARIOUS WAITING RESTRICTIONS  
**BY:** Head of Amenities & Environmental Services  
**Classification:** Unrestricted

---

**Summary:** A report for members to consider results of recent consultation carried out in various locations in relation to proposed waiting restrictions, and also to consider formal objections received following the recent advertising of Traffic Regulation Orders in Swale.

---

**Implications:**

---

Human Resources Implications - None

---

Finance Implications – None

---

Legal Implications – Traffic Regulation Orders to be made

---

Crime & Disorder Implications (Section 17) - None

---

Equalities & Diversity Implications – None

---

Sustainability Implications – None

---

Risk and Health and Safety Implications – None

---

Corporate Plan Implications – Improving Community Safety through safer Highways.

---

**Decision Required:** **That Members note the report and await consultation results submitted at the meeting:**

- **Millen Road, Milton Regis, Sittingbourne**
- **Sheerness Gateway Building, High Street, Sheerness**

**That Members note the report and recommend that officers do not install the following waiting restrictions:**

- **Glebe Lane/Temple Gardens, Sittingbourne**

---

### Introduction/Background

1. A consultation has been undertaken with residents and statutory consultees in relation to the introduction of new waiting restrictions within the Borough. These proposals have come from various sources such as residents' letters, parish/town council correspondence and residents' petitions..
2. The plans of the proposed restrictions have been included in Annex A.

### Issue for Decision

3. Objections to the proposals are included within Annex B. The locations will be discussed in the following paragraphs. Where corner protection measures are being introduced, Kent Police have requested that a minimum waiting restriction distance of 10 metres should be adopted. However, in areas where parking demand is high this will greatly reduce local parking capacity. The proposals for corner protection in this report do meet the requirement where possible, however in some locations

the need for a waiting restriction has been balanced against the need for parking, so in some instances the corner protection may have been reduced to 5 metres.

#### **4. Millen Road, Milton Regis, Sittingbourne**

Following a request from the managers of a local company, located in Millen Road, Milton Regis, it is proposed to install double yellow lines on either side of the vehicle entrance to Ingersoll Rand. Problems are currently being experienced with larger vehicles and HGVs gaining access to the site due the large number of commuters' vehicles parked in close proximity to the entrance. This has resulted in delays, and in some cases the cancellation of deliveries to and from the factory. To minimise the impact on parking in the area, it has been agreed with the company that the restrictions will consist of double yellow lines, 7.5 metres in length in the southern direction and 18 metres in length in the northern direction, either side of the entrance, but for no restrictions to be installed opposite the entrance.

As there are few properties in the area, only two consultation documents have been sent out. As the closing date for the consultation is after the submission of this report, any objections received will be reported to the Joint Transportation Board at the meeting.

Recommendations will be provided at the meeting based on the feedback received from the consultation.

#### **5. Sheerness Gateway Building, High Street, Sheerness**

A request has been made by the Project Team of the new Sheerness Gateway building, located in the former Woolworths building in Sheerness High Street, for a drop off point to be provided in the existing lay-by outside of the property to assist visitors and customers. Although there is no formal road marking and associated Traffic Regulation Order for the provision of such a facility detailed in the Traffic Signs Manual, motorists are permitted to stop on double yellow lines for the purposes of loading and unloading, which includes dropping off and collecting passengers, and it is therefore proposed to install approximately 11 metres of double yellow lines outside of the premises.

In addition to these restrictions, it is also proposed to install two new disabled persons' parking bays adjacent to the new double yellow lines, to assist disabled road users and to alleviate the need for blue badge holders to park on the new restrictions. The remaining half of the lay-by will remain unrestricted to maintain parking for other road users.

The closing date for the consultation on these restrictions is after the submission of this report, and any objections and comments will therefore be reported to the Joint Transportation Board at the meeting for consideration.

Recommendations will be provided at the meeting based on the feedback received from the consultation.

#### **6. Glebe Lane/Temple Gardens, Sittingbourne**

A request was received from a resident asking to install parking restrictions at the junction of Glebe Lane and Temple Gardens, Sittingbourne. The resident stated that vehicles parked close to the junction and created visibility problems for vehicles using this junction. A consultation took place proposing the installation of double yellow lines at this junction.

Out of the 28 properties consulted, 4 supported the proposals and 6 objected to the proposals. Details of the objections received can be found in Annex B.

In view of the limited response and the consultation results, it is considered that the restrictions may not be justified at this time, but to monitor the location and act on any requests by the Emergency Services that we may receive in the future.

## **Recommendation**

Members are asked to note the comments/objections made by the consultees and recommend that the following waiting restrictions are not installed and that the consultees are notified accordingly.

- Glebe Lane/Temple gardens, Sittingbourne

## **Reasons for the Recommendation**

Due to a poor response and the objections received, installation of the proposed parking restrictions may not be justified. The site is to be monitored.

Author: Brett O'Connell/Mike Knowles - Tel: 01795 417061/417125

Date: 23<sup>rd</sup> February 2011

Report approved by – Head of Amenities & Environmental Services

List of background documents –

Annex A – Copy of consultation material

Annex B – Copy of the objector's comments

## Waiting Restrictions - ANNEX B

### Glebe Lane/ Temple Gardens, Sittingbourne

#### Recommendation – Not to Install

Comment No.	Objectors Comments
1	I am disabled and rely on my family to pick me up; they would not be able to park outside.
2	No problems with parking at this area. Wife is disabled where is she going to park
3	Already have trouble parking due to rented housing pushing us out. If it goes ahead pushed us further back to next road which you would have same problem. People already park on that corner with no one complaining about it.
4	Hard enough for residents to park now. There are already a few people from Glebe Lane park in Temple Gardens by introducing yellow lines, it will only add to the problem of parking in Temple Gardens. What measures will you be taking to ensure the residents of Temple Gardens can still park in their own road. (ie numbered parking bays/ residents parking)
5	I am registered disabled and am virtually unable to walk. I have parked my car at the front of our house for over 30 years, so I only have to walk down the path. My family park at the side of the property. If the double yellow lines came to where the white broken give way lines at the bottom of Temple Gardens and not beyond, it would give me room to park in front of my property. I noticed that at the top of St Johns Avenue. the double yellow lines are just on the corner and do not come round. This decision will affect if I am able to get out.
6	We have never had visibility problems in 3 1/2 years we lived here. Have had parking problems, if proposed yellow lines go ahead the problems will get worse, due to cars that are unable to park in Glebe Lane will park in the Temple Gardens cul de sac. The garages are not big enough to park anything except a very small car.

# ANNEX A

RESIDENT/OCCUPIER

Please ask for: Mr Brett O'Connell  
Direct Line: 01795 417061  
Fax: 01795 417477  
E-mail: brettoconnell@swale.gov.uk  
Our Ref:  
Date: 7<sup>th</sup> February 2011

Dear Resident/Occupier

## Proposed Double Yellow Lines – Glebe Lane/Temple Gardens, Sittingbourne

Swale Borough Council is proposing to introduce double yellow lines in Glebe Lane at the junction of Temple Gardens, Sittingbourne, as detailed on the plan.

It is proposed to introduce the double yellow lines to improve vehicle movements and visibility.

If you support or object to the proposal please complete the reply slip and return to the Borough Council before **Monday 21<sup>st</sup> February 2011**. A space has also been provided to allow you to add any further comments you may have.

The installation of any parking restriction will depend on the funding available.

If you have any further queries, please do not hesitate to contact Brett O'Connell on 01795 417061.

Yours sincerely

*Brett O'Connell*

Brett O'Connell  
Assistant Engineer  
Swale Borough Council

# ANNEX A

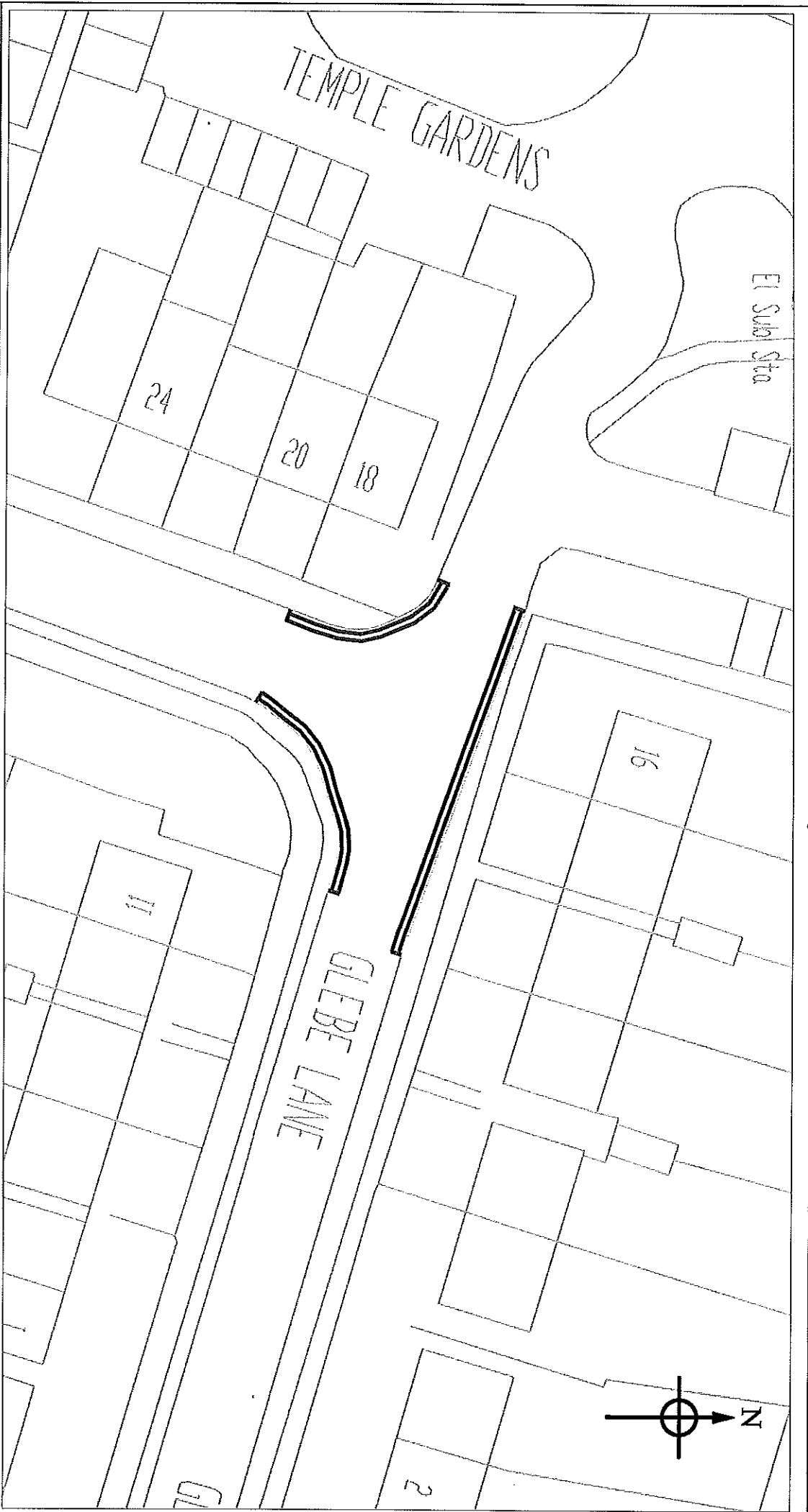

## Key

==== Proposed Double Yellow Lines

DRAWN	BOC
DATE	Feb 11
SCALE	NTS

Glebe Lane Junction Temple Gardens,  
Sittingbourne - Proposed Waiting Restrictions

ES/2738/112

Her Majesty's Stationery Office © Crown copyright. Unauthorised reproduction infringes Crown copyright and may lead to prosecution or civil proceedings.  
Swale Borough Council, L4679Xeb, 2011



# ANNEX A



## Proposed Double Yellow Lines Millen Road, Sittingbourne

Following a request from the nearby business, it is proposed to install double yellow lines on either side of the vehicle entrance to Ingersoll Rand in Millen Road, Sittingbourne.

The restrictions are proposed to keep the access clear of parked vehicles, which are currently hampering lorry access in and out of the entrance to the loading/unloading area. The lining has been kept to a minimum to reduce the impact of parking in Millen Road.

If you support or object to the proposal please complete the reply slip below and return to the Borough Council in the pre-paid envelope provided, before Friday 18<sup>th</sup> February 2011. A space has also been provided to allow you to add any further comments you may have.

---

### Proposed Double Yellow Lines – Millen Road, Sittingbourne

Please tick one of the following boxes

I Support the proposal to install double yellow lines       I Object to the proposal

Name & Address	Comments

The information supplied will only be used in conjunction with this proposal, and used for geographical analysis purposes only





# ANNEX A



## Proposed Double Yellow Lines & Disabled Persons Parking Bays – High Street, Sheerness

Following a request from the project team of the new Sheerness Gateway building in Sheerness High Street, it is proposed to install a short length of double yellow lines and two disabled persons parking bays in the existing lay-by in the vicinity of the building.

The purpose of the double yellow lines is to provide an area for dropping off and collecting visitors to the offices, with the provision of two new disabled persons parking bays for visitors to the town centre with blue badges. The proposals will restrict approximately half of the existing lay-by, leaving the remaining half available for other visitors to the town centre.

If you support or object to the proposals please complete the reply slip below and return to the Borough Council in the pre-paid envelope provided, before Friday 25<sup>th</sup> February 2011. A space has also been provided to allow you to add any further comments you may have.

---

### Proposed Double Yellow Lines & Disabled Persons Parking Bays High Street, Sheerness

Please tick one of the following boxes

I Support the proposals to install double yellow lines and disabled persons bays

I Object to the proposals

Name & Address	Comments

The information supplied will only be used in conjunction with this proposal, and used for geographical analysis purposes only

# ANNEX A



## Plan of proposed restrictions

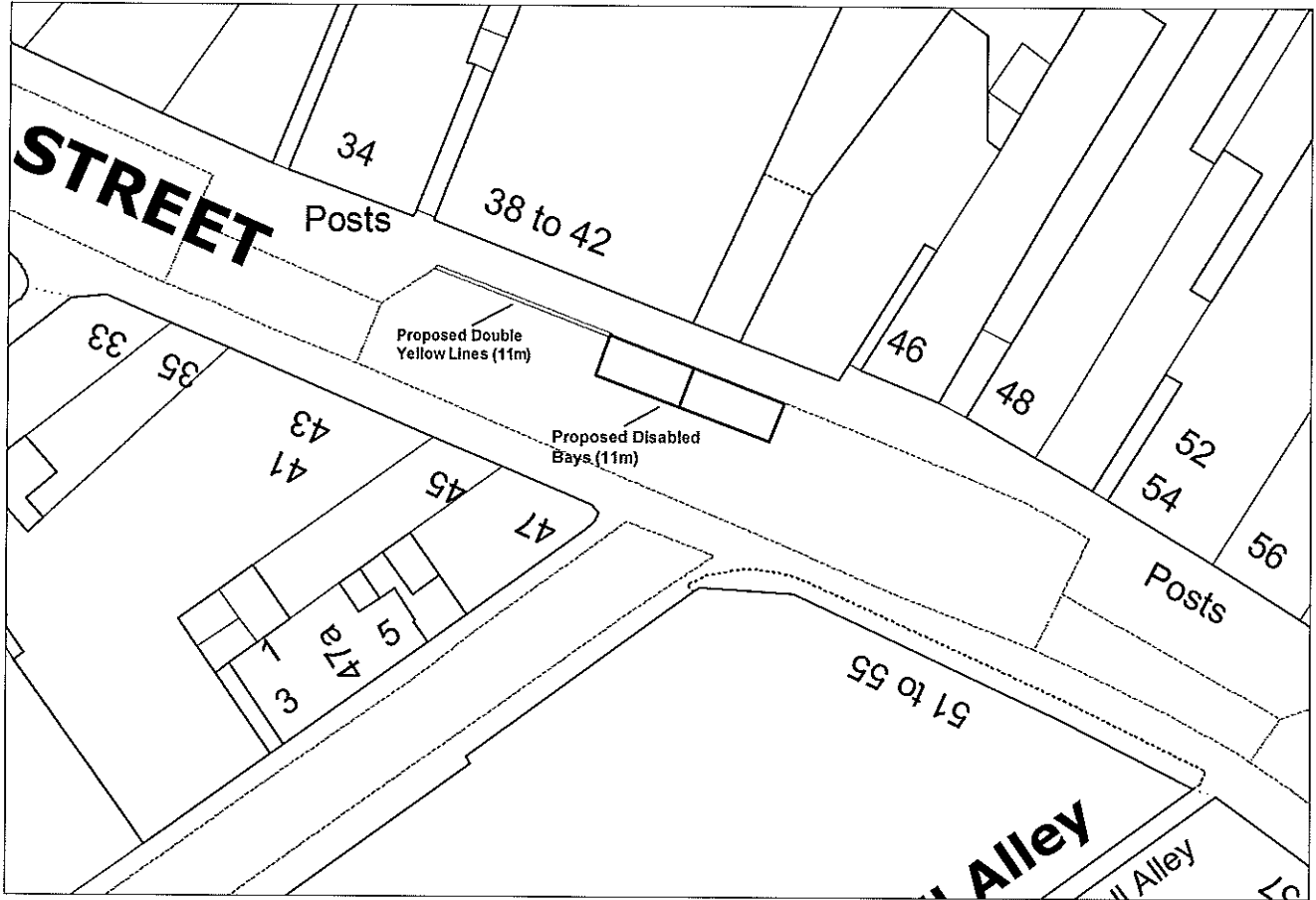

ADDRESS BLOCK